

ANSI CLASS150 SLIP ON FLANGES

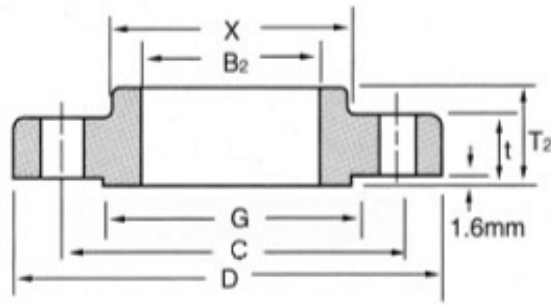

UNIT:mm

Size	Flange			Raised Face Dia G	Length thru hub 2 T2	Drilling			Dia of hub At Base X	Weight (kgs/pc)
	Out Dia	Bore	Thickness			No.	Dia of Hole	Dia of bolt Circle		
	D	B2	t					C		
1/2"	89	22.4	11.2	35.1	15.7	4	15.7	60.5	30.2	0.41
3/4"	98	27.7	12.7	42.9	15.7	4	15.7	69.9	38.1	0.57
1"	108	34.5	14.2	50.8	17.5	4	15.7	79.2	49.3	0.78
1 1/4"	117	43.2	15.7	63.5	20.6	4	15.7	88.9	58.7	1.03
1 1/2"	127	49.5	17.5	73.2	22.4	4	15.7	98.6	65	1.32
2"	152	62	19.1	91.9	25.4	4	19.1	120.7	77.7	2.09
2 1/2"	178	74.7	22.4	104.6	28.4	4	19.1	139.7	90.4	3.25
3"	191	90.7	23.9	127.0	30.2	4	19.1	152.4	108.0	3.91
3 1/2"	216	103.4	23.9	139.7	31.8	8	19.1	177.8	122.2	4.99
4"	229	116.1	23.9	157.2	33.3	8	19.1	190.5	134.9	5.35
5"	254	143.8	23.9	185.7	36.6	8	22.4	215.9	163.6	6.22
6"	279	170.7	25.4	215.9	39.6	8	22.4	241.3	192	7.76
8"	343	221.5	28.4	269.7	44.5	8	22.4	298.5	246.1	12.60
10"	406	276.4	30.2	323.9	49.3	12	25.4	362	304.8	19.50
12"	483	327.2	31.8	381.0	55.6	12	25.4	431.8	365.3	29.00
14"	533	359.2	35.1	412.8	57.2	12	28.4	476.3	400.1	41.00
16"	597	410.5	36.6	469.9	63.5	16	28.4	539.8	457.2	44.50
18"	635	461.8	39.6	533.4	68.3	16	31.8	577.9	505	59.00
20"	699	513.1	42.9	584.2	73.2	20	31.8	635.0	558.8	75.00
24"	813	616.0	47.8	692.2	82.6	20	35.1	749.3	663.4	99.80