

ANSI CLASS150 SOCKET WELD FLANGES

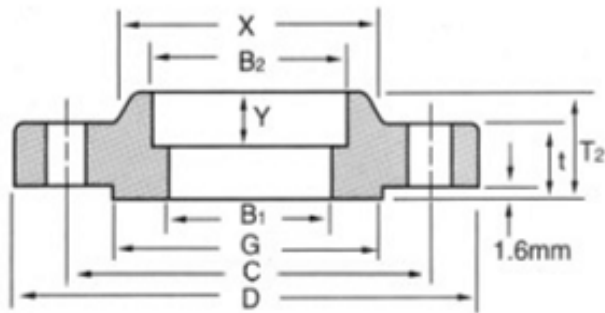

UNIT:mm

Size	Flange				Raised Face Dia G	Length thru hub T2	Drilling			Dia of hub At Base X	Depth of Socket Y	Weight (kgs/pc)
	Out Dia D	Bore		Thick ness t			No.	Dia of Hole	Dia of bolt Circle C			
		B2	B1									
1/2"	89	22.4	15.8	11.5	35.1	15.7	4	15.7	60.5	30.2	9.7	0.47
3/4"	98	27.7	20.8	13.0	42.9	15.7	4	15.7	69.9	38.1	11.2	0.59
1"	108	34.5	26.7	14.5	50.8	17.5	4	15.7	79.2	49.3	12.7	0.87
1 1/4"	117	43.2	35.1	16.0	63.5	20.6	4	15.7	88.9	58.7	14.2	1.11
1 1/2"	127	49.5	40.9	17.5	73.2	22.4	4	15.7	98.6	65	15.7	1.45
2"	152	62	52.6	19.5	91.9	25.4	4	19.1	120.7	77.7	17.5	2.33
2 1/2"	178	74.7	62.7	22.5	104.6	28.4	4	19.1	139.7	90.4	19.1	3.55
3"	191	90.7	78.0	24.0	127.0	30.2	4	19.1	152.4	108	20.6	4.02
3 1/2"	216	103.4	90.2	24.0	139.7	31.8	8	19.1	177.8	122.2	22.4	4.99
4"	229	116.1	102.4	24.0	157.2	33.3	8	19.1	190.5	134.9	23.9	5.99
5"	254	143.8	128.3	24.0	185.7	36.6	8	22.4	215.9	163.6	23.9	6.68
6"	279	170.7	154.2	25.5	215.9	39.6	8	22.4	241.3	192	26.9	7.99
8"	343	221.5	202.7	29.0	269.7	44.5	8	22.4	298.5	246.1	31.8	13.29
10"	406	276.4	254.5	30.5	323.9	49.3	12	25.4	362	304.8	33.3	19.50
12"	483	327.2	304.8	32.0	381.0	55.6	12	25.4	431.8	365.3	39.6	29.03
14"	533	359.2	336.6	35.0	412.8	57.2	12	28.4	476.3	400.1	41.4	38.56
16"	597	410.5	387.1	37.0	469.9	63.5	16	28.4	539.8	457.2	44.5	44.49
18"	635	461.8	438.2	40.0	533.4	68.3	16	31.8	577.9	505	49.3	54.43
20"	699	513.1	489	43.0	584.2	73.2	20	31.8	635.0	558.8	54.1	70.31
24"	813	616.0	590.6	48.0	692.2	82.6	20	35.1	749.3	663.4	63.5	95.25

ANSI CLASS150 SOCKET WELD FLANGES

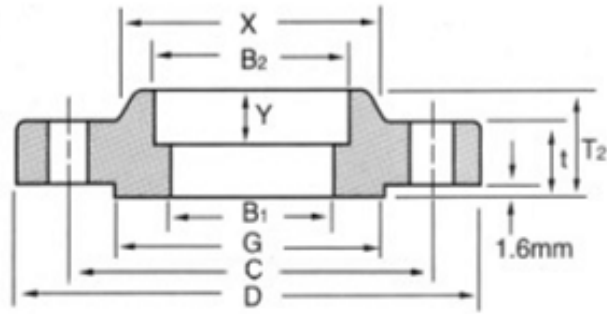

UNIT:mm

Size	Flange				Raised Face Dia G	Length thru hub T ₂	Drilling			Dia of hub At Base X	Depth of Socket Y	Weight (kgs/pc)
	Out Dia D	Bore		Thick ness t			No.	Dia of Hole	Dia of bolt Circle C			
		B ₂	B ₁									
1/2"	95	22.4	15.7	14.2	35.1	22.4	4	15.7	66.5	38.1	9.7	0.62
3/4"	117	27.7	20.8	15.7	42.9	25.4	4	19.1	82.6	47.8	11.2	1.19
1"	124	34.5	26.7	17.5	50.8	26.9	4	19.1	88.9	53.8	12.7	1.44
1 1/4"	133	43.2	35.1	19.1	63.5	26.9	4	19.1	98.6	63.5	14.2	1.73
1 1/2"	155	49.5	40.9	20.6	73.2	30.2	4	22.4	114.3	69.9	15.7	2.62
2"	165	62	52.6	22.1	91.9	33.3	8	19.1	127	84.1	17.5	2.94
2 1/2"	191	74.7	62.7	25.4	104.6	38.1	8	22.4	149.4	100.1	19.1	4.49
3"	210	90.7	78.0	28.4	127.0	42.9	8	22.4	168.1	117.3	20.6	6.20
3 1/2"	229	103.4	90.2	30.2	139.7	44.5	8	22.4	184.2	133.4	22.4	-
4"	254	116.1	102.4	31.8	157.2	47.8	8	22.4	200.2	146.1	23.9	-
5"	279	143.8	128.3	35.1	185.7	50.8	8	22.4	235	177.8	23.9	-
6"	318	170.7	154.2	36.6	215.9	52.6	12	22.4	269.7	206.2	26.9	-
8"	381	221.5	202.7	41.1	269.7	62	12	25.4	330.2	260.4	31.8	-
10"	445	276.4	254.5	47.8	323.9	66.5	16	28.4	387.4	320.5	33.3	-
12"	521	327.2	304.8	50.8	381.0	73.2	16	31.8	450.9	374.7	39.6	-
14"	584	359.2	336.6	53.8	412.8	76.2	20	31.8	514.4	425.5	41.4	-
16"	648	410.5	387.4	57.2	469.9	82.6	20	35.1	571.5	482.6	44.5	-
18"	711	461.8	438.2	60.5	533.4	88.9	24	35.1	628.7	533.4	49.3	-
20"	775	513.1	489	63.5	584.2	95.3	24	35.1	685.8	587.2	54.1	-
24"	914	616.0	590.6	69.9	692.2	106.4	24	41.1	812.8	701.5	63.5	-

ANSI CLASS150 SOCKET WELD FLANGES

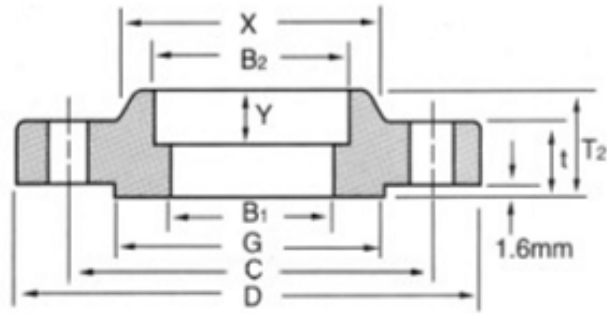

UNIT:mm

Size	Flange				Raised Face Dia G	Length thru hub T2	Drilling			Dia of hub At Base X	Depth of Socket Y	Weight (kgs/pc)
	Out Dia D	Bore		Thick ness t			No.	Dia of Hole	Dia of bolt Circle C			
		B2	B1									
1/2"	95	22.4	15.8	14.2	35.1	22.4	4	15.7	66.5	38.1	9.7	0.91
3/4"	117	27.7	20.9	15.7	42.9	25.4	4	19.1	82.6	47.8	11.2	1.36
1"	124	34.5	26.6	17.5	50.8	26.9	4	19.1	88.9	53.8	12.7	1.81
1 1/4"	133	43.2	35.1	20.6	63.5	28.4	4	19.1	98.6	63.5	14.2	2.60
1 1/2"	155	49.5	40.9	22.4	73.2	31.8	4	22.4	114.3	69.9	15.7	3.18
2"	165	62	52.5	25.4	91.9	36.6	8	19.1	127.0	84.1	17.5	3.90
2 1/2"	191	74.7	62.7	28.4	104.6	41.1	8	22.4	149.4	100.1	19.1	5.90
3"	210	90.7	77.9	31.8	127.0	46.0	8	22.4	168.1	117.3	20.6	7.40
3 1/2"	229	103.4	90.1	35.1	139.7	49.3	8	25.4	184.2	133.4	22.4	-
4"	273	116.1	102.3	38.1	157.2	53.8	8	25.4	215.9	152.4	23.9	-
5"	330	143.8	128.3	44.5	185.7	60.5	8	28.4	266.7	189	23.9	-
6"	356	170.7	154.1	47.8	215.9	66.5	12	28.4	292.1	222.3	26.9	-
8"	419	221.5	202.7	55.6	269.7	76.2	12	31.8	349.3	273.1	31.8	-
10"	508	276.4	254.5	63.5	323.9	85.9	16	35.1	431.8	342.9	33.3	-
12"	559	327.2	303.2	66.5	381.0	91.9	20	35.1	489	400.1	39.6	-
14"	603	359.2	333.3	69.9	412.8	93.7	20	38.1	527.1	431.8	41.4	-
16"	686	410.5	381	76.2	469.9	106.4	20	41.1	603.3	495.3	44.5	-
18"	743	461.8	428.7	82.6	533.4	117.3	20	44.5	654.1	546.1	49.3	-
20"	813	513.1	477.8	88.9	584.2	127.0	24	44.5	723.9	609.6	54.1	-
24"	940	616.0	547.6	101.6	692.2	139.7	24	50.8	838.2	717.6	63.5	-